

# Florida International University

## Campus Master Plan: 2005-2015 Update

FIU Board of Trustees Presentation

September 2010



# Master Plan Update: Requirements and Objectives

- **F.S. 1013.30 requires all universities update their 10 year master plan every 5 years**
- **Measure and assess current FIU impacts on host communities**
  - **Public facilities**
  - **Services**
  - **Natural resources**
- **Communicate FIU growth requirements to host communities**
  - **Academic, research, support and housing facilities**
- **Manage and coordinate FIU growth impacts with host communities**
  - **Land use density and intensity**
  - **Recreation, open space and conservation**
  - **Circulation and site infrastructure**
- **Record how FIU wants to grow**
  - **General locations of structures, intensities of use and development standards**
- **Guide FIU growth decisions, capital planning and implementation**

# University-Wide Campus Master Plan Elements

- Master Plan Elements \*
  - 1.0 Academic Mission
  - 2.0 Academic Program
  - 3.0 Urban Design
  - 4.0 Future Land Use
  - 5.0 Academic & Research Facilities
  - 6.0 Support Facilities
  - 7.0 Housing
  - 8.0 Recreation and Open Space
  - 9.0 General Infrastructure
  - 10.0 Utilities
  - 11.0 Transportation
  - 12.0 Intergovernmental Coordination
  - 13.0 Conservation
  - 14.0 Capital Improvements
  - 15.0 Architectural Design Guidelines
  - 16.0 Landscape Architectural Design Guidelines
  - 17.0 Facilities Maintenance
  - 18.0 Coastal Management

\* Those requiring review by Host Community Government Agencies are highlighted in red.



# Major Issues: 2007 Evaluation / Appraisal Report

Results from evaluating previous master plan and extensive focus group discussions.

- **Shortage of Academic / Research Space**
- **Parking Availability / Accessibility**
- **Traffic Congestion / Roadway Capacity**
- **Student Housing Demand**
- **Recreation & Open Space Preservation**
- **Land Use Constraints**
- **Future of Biscayne Bay & Engineering Center Campuses**
- **Campus Image / Identity**
- **New College of Medicine and Health Sciences and Research Expansion**

# Strategic Assumptions: 2008

- Growth rate = 2% per year at MMC and BBC
- Engineering Center accounts for 10% MMC FTE
- Plan based on unconstrained resources
- 5 Year CIP included projects planned, funded and under construction
- \$135M/YR Capital Financing for 5 Years
- Undergraduate student body:
  - Lower division = 42% of FTE
  - Upper division = 58% of FTE
- Housing Target = 20% of total undergraduate FTS
  - Existing = 3009 beds
  - Total = 4827 beds required
- Parking Target = 34% of FTE + .5 Resident Student
  - Existing = 10,986 Spaces
  - Total = 10,619 Spaces required



# FIU Campus Guiding Principles

- Develop a **sustainable** campus environment
- Develop forward looking, **innovative and interdisciplinary** learning and research environments
- **Reinforce FIU's identity** through the articulation of landmarks, precincts, edges, buildings, and open spaces
- Create a more **compact urban environment**
- Develop comprehensive **multi-modal solutions to transportation** & infrastructure
- Establish better **connectivity with neighboring communities**
- Create a safe, connected, **pedestrian-friendly** campus
- Site core academic programs along **main axes**
- Develop **student life mixed use communities**
- Foster learning through **multipurpose open space**

# Modesto A. Maidique Campus



# Modesto A. Maidique Campus & Engineering Center Context

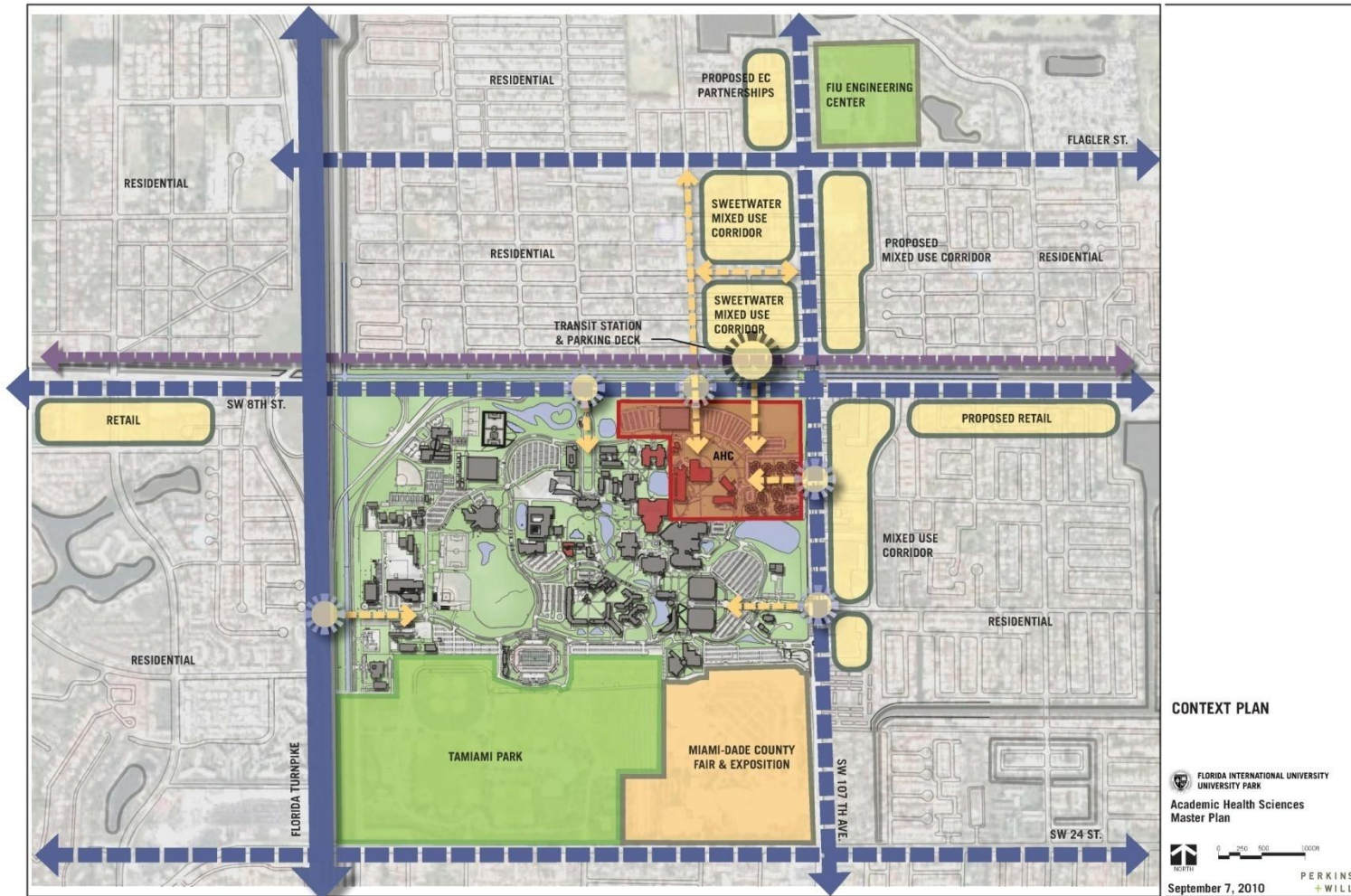





# Modesto A. Maidique Campus

## 2015 Space Needs

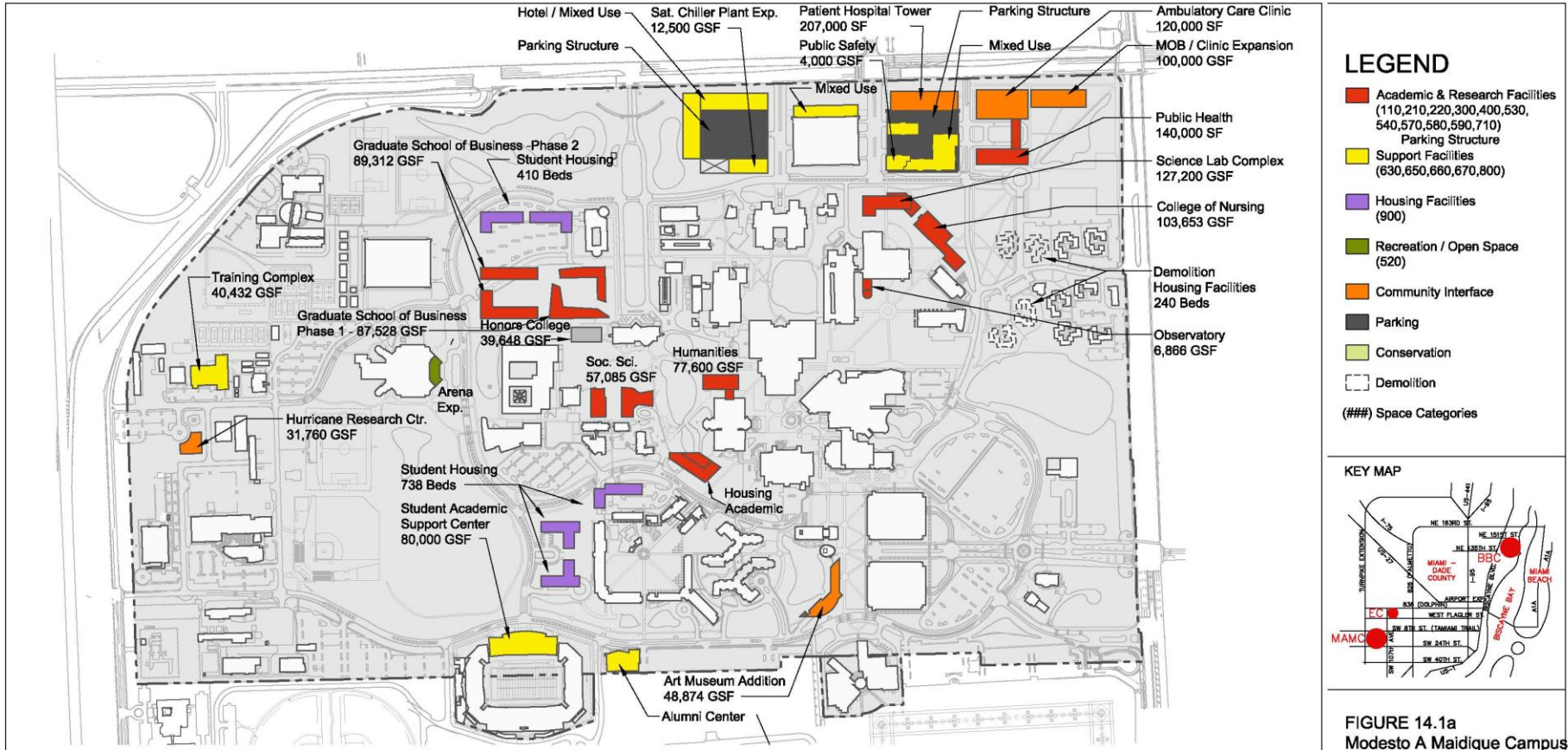

### LEGEND

- Academic & Research Facilities (110,210,220,300,400,530, 540,570,580,590,710)
- Support Facilities (630,650,660,670,800)
- Housing Facilities (900)
- Recreation / Open Space (520)
- Community Interface
- Parking
- Conservation
- Demolition

(###) Space Categories



FIGURE 14.1a  
Modesto A Maidique Campus  
2015 Space Needs

### Planned or Under Construction (2006-2011)

<span style="color: red;">■</span> Academic & Research Facilities 728,892 GSF	<span style="color: yellow;">■</span> Support Facilities 136,932 GSF	<span style="color: purple;">■</span> Housing Facilities 1,148 Beds, 401,800 GSF	<span style="color: orange;">■</span> Community Interface 507,634 GSF
--	---	---	--

### Additional 2015 Space Needs

<span style="color: red;">■</span> Academic & Research Facilities 639,518 GSF (assumes 6 story massing)	<span style="color: yellow;">■</span> Support Facilities 238,391 GSF (assumes 4 story massing)	<span style="color: purple;">■</span> Housing Facilities 556 Beds, 194,600 GSF (assumes 41 beds per floor requires 7 story massing)	<span style="color: orange;">■</span> Community Interface (no additional space needed)	<span style="color: green;">■</span> Recreation / Open Space 17,359 GSF (assumes 1 story massing)
---	--	---	---	---

### Total - Planned and Additional Needs

<span style="color: red;">■</span> Academic & Research Facilities 1,368,410 GSF	<span style="color: yellow;">■</span> Support Facilities 375,323 GSF	<span style="color: purple;">■</span> Housing Facilities 1,148 Beds, 401,800 GSF	<span style="color: orange;">■</span> Community Interface 507,634 GSF	<span style="color: green;">■</span> Recreation / Open Space 17,359 GSF
--	---	---	--	--

**FIU** FLORIDA INTERNATIONAL UNIVERSITY  
Campus Master Plan - June 2010

**PERKINS + WILL**

# Modesto A. Maidique Campus

Existing



# Modesto A. Maidique Campus

2015



FIGURE: 0.1d  
Modesto A. Maidique Campus  
3D Diagram-2015

# Modesto A. Maidique Campus

## Vision Plan



# Engineering Center





# Engineering Center

## 2015 Space Needs



### Planned or Under Construction (2006-2011)

Academic & Research Facilities 27,840 GSF	Community Interface 1,981 GSF
--	----------------------------------

### Additional 2015 Space Needs

Academic & Research Facilities  
35,112 GSF  
(assumes 2 story massing)

Support Facilities  
13,875 GSF  
(assumes 1 story massing)

### Total - Planned and Additional Needs

Academic & Research Facilities 62,952 GSF	Community Interface 1,981 GSF
--	----------------------------------

Support Facilities  
13,875 GSF

### LEGEND

- Academic & Research Facilities  
(110,210,220,300,  
400,530,590,710)
  - Support Facilities  
(630,650,660,670,800)
  - Housing Facilities  
(900)
  - Recreation / Open Space  
(520)
  - Community Interface
  - Parking
  - Conservation
  - Demolition
- (###) Space Categories

### KEY MAP

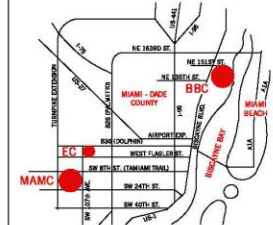

FIGURE 14.2a  
Engineering Center  
2015 Space Needs

**FIU** FLORIDA INTERNATIONAL UNIVERSITY

Campus Master Plan - June 2010



**PERKINS + WILL**





# Engineering Center

2015

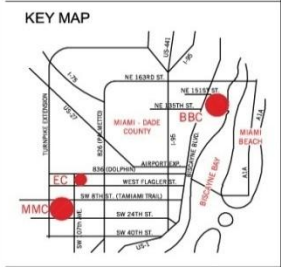
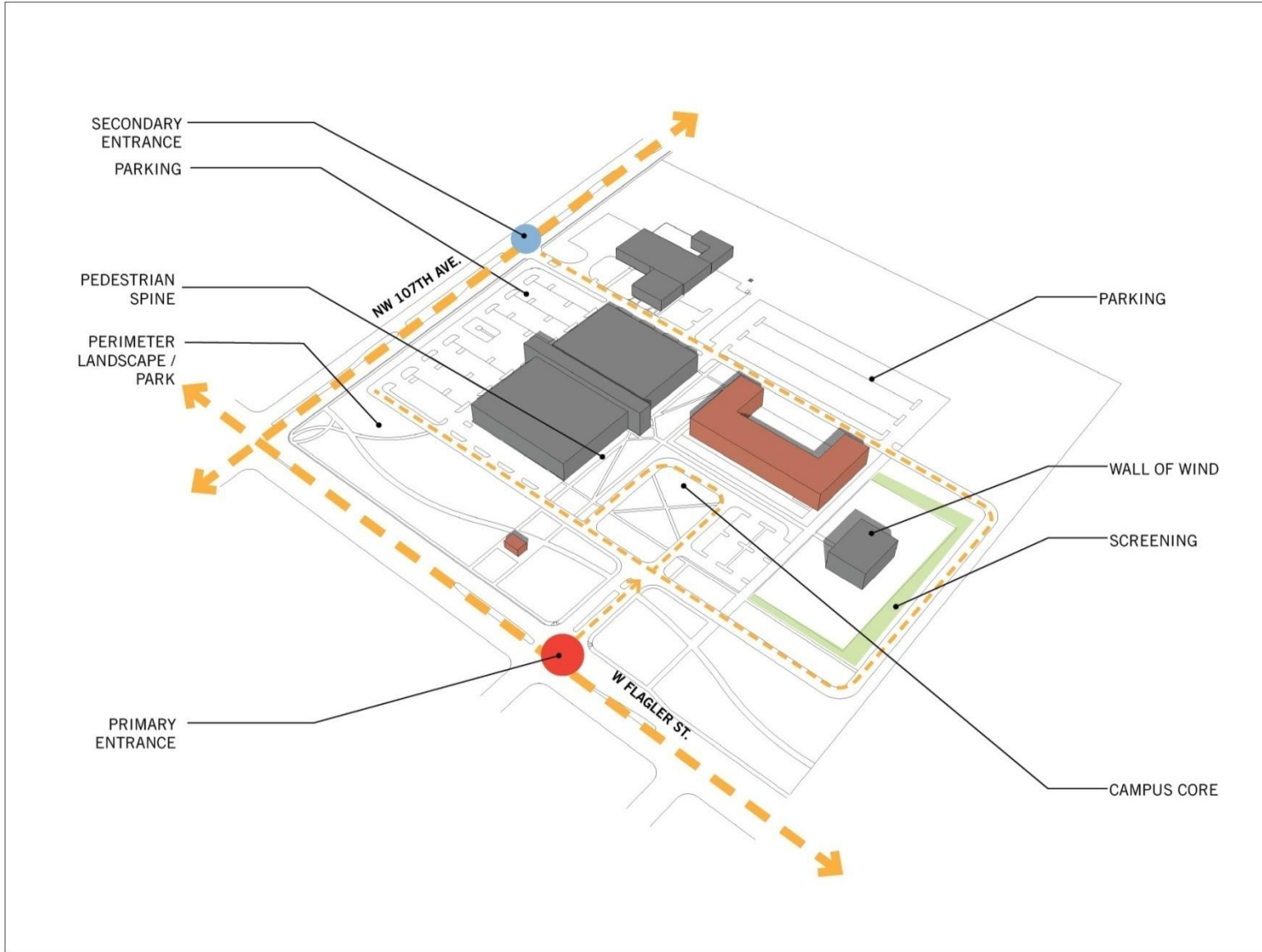

**FIGURE: 0.2d**  
Engineering Center  
3D Diagram-2015

# Engineering Center

## Vision Plan

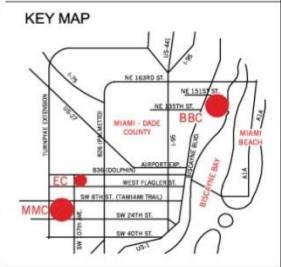
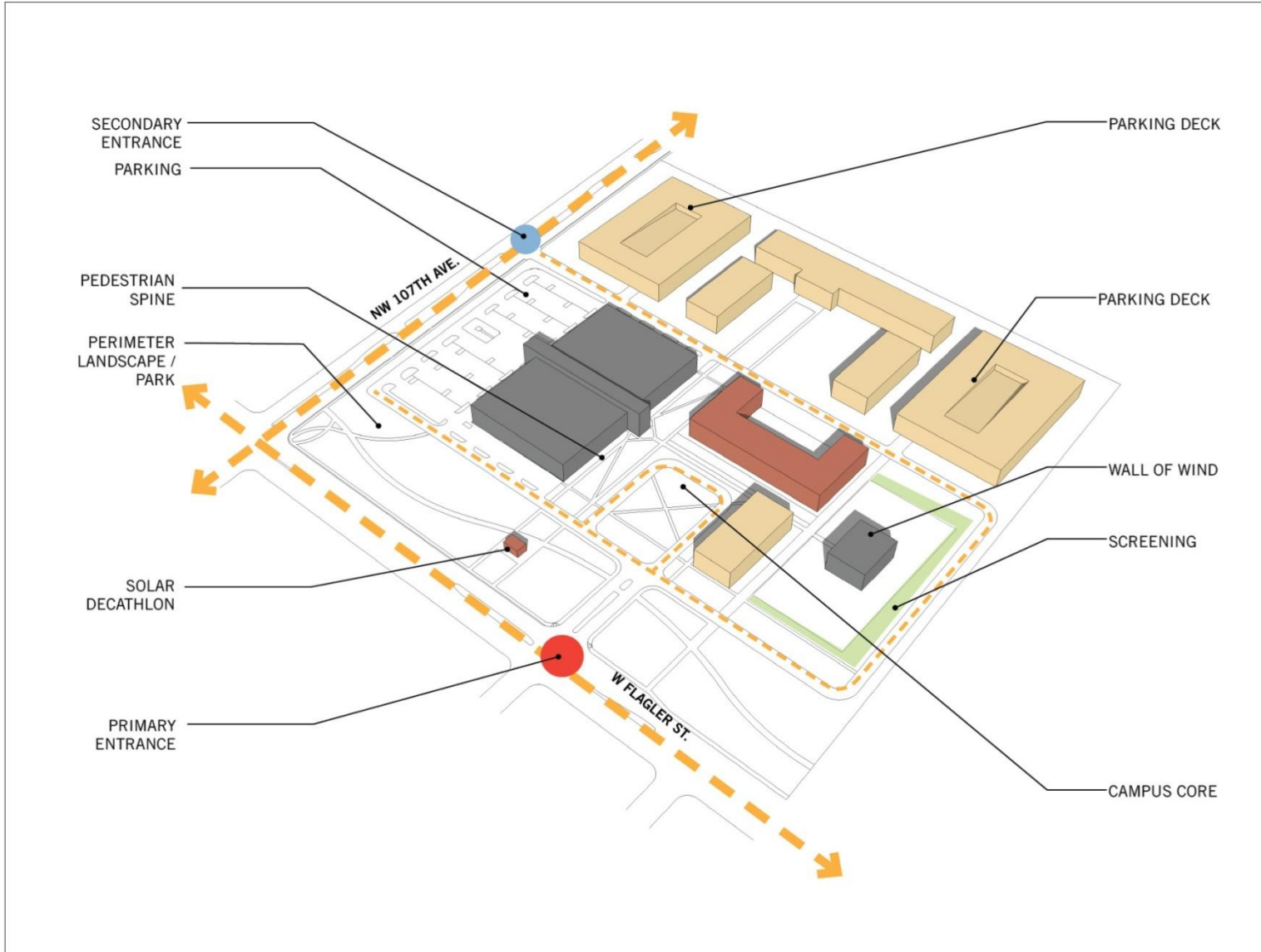

**FIGURE: 0.2e**  
Engineering Center  
3D Diagram-Vision

# Biscayne Bay Campus



# Biscayne Bay

## Context Area Map

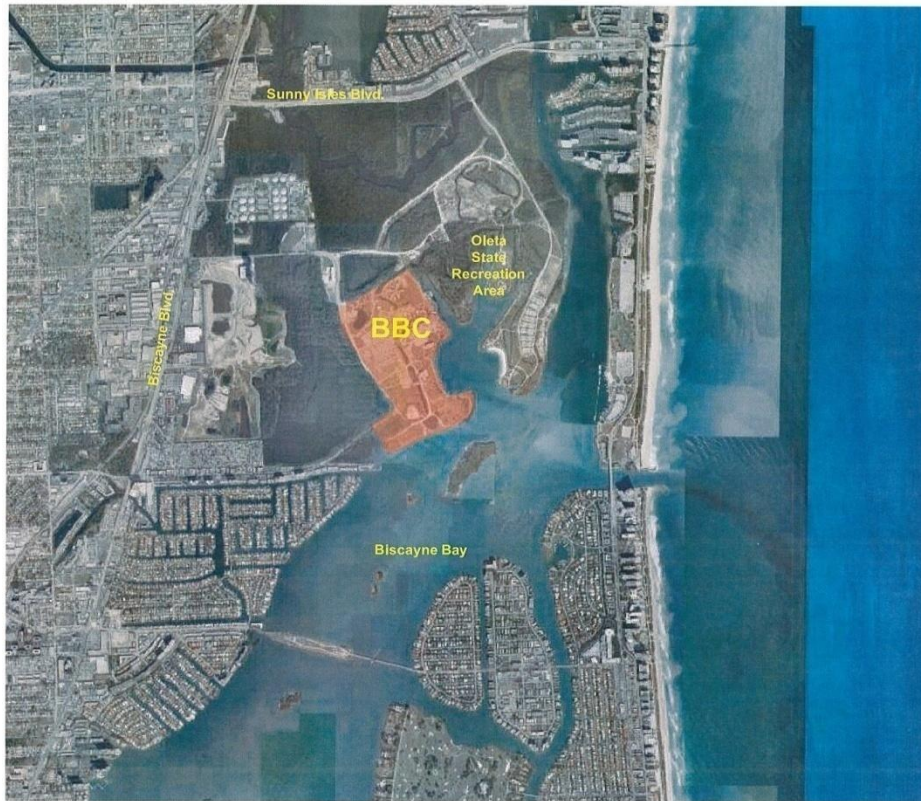

### LEGEND

 Biscayne Bay Campus

### KEY MAP

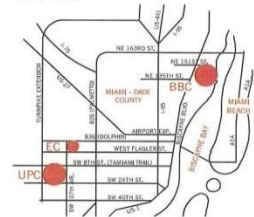

FIGURE 4.3a  
Biscayne Bay Campus  
Context Area Map

**FIU** FLORIDA  
INTERNATIONAL  
UNIVERSITY

Campus Master Plan - June 3, 2009



**PERKINS  
+ WILL**

# Biscayne Bay

## Land Use









# Biscayne Bay

2015

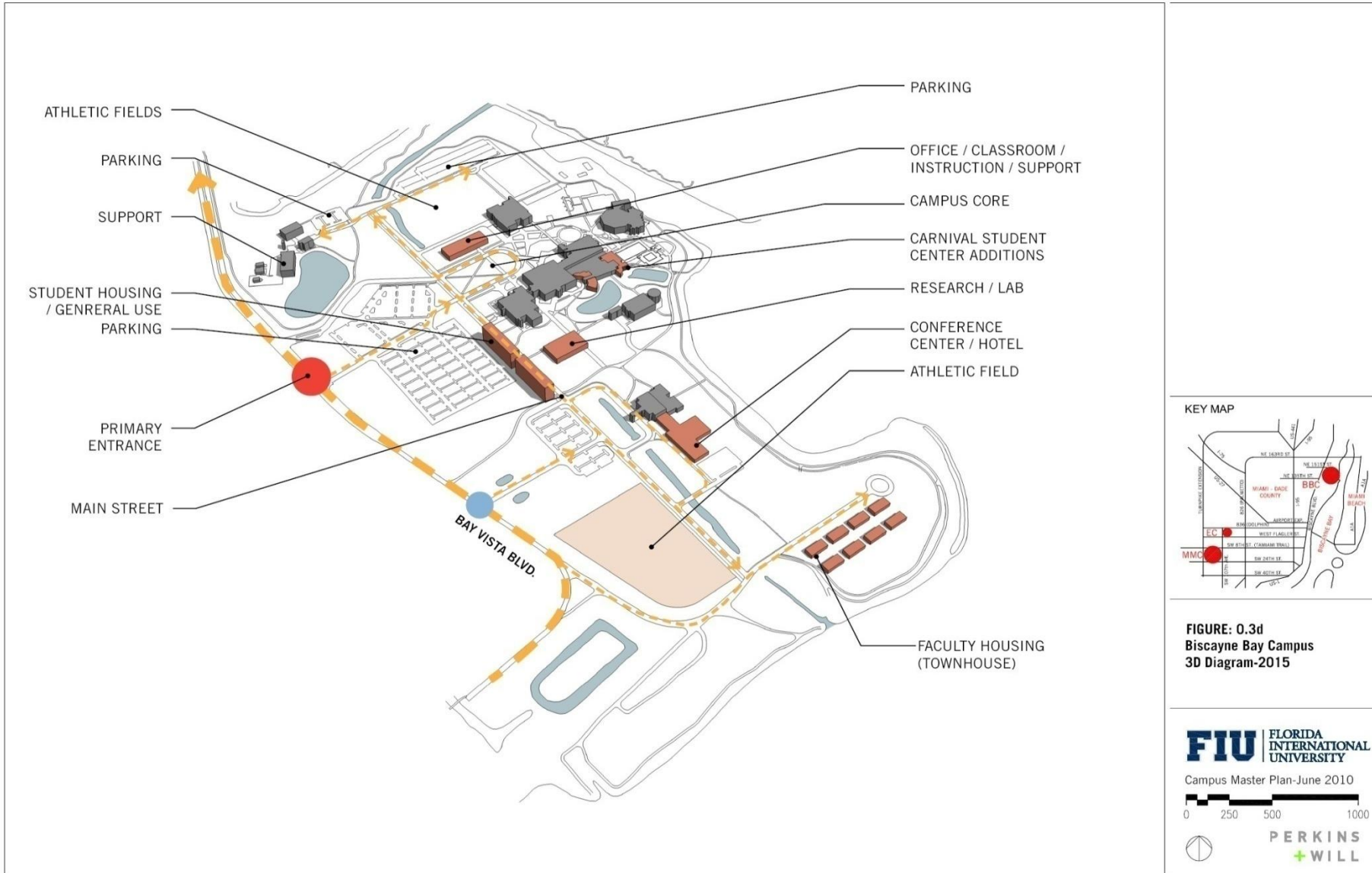

# Biscayne Bay

## Vision Plan

